



KEY FEATURES

- Passive two-way point source
- 8" neodymium woofer
- 1" HF compression driver with 1" aluminum VC
- Audiophile-grade passive crossover
- Custom-designed, wide-coverage HF horn
- Lightweight and durable PP enclosure
- Symmetrical 42° wedge angle for stage monitoring
- M8 rigging points
- Pole mount socket

APPLICATIONS

- Corporate and A/V
- TV and broadcast
- Stage monitoring
- Live music venues
- Bars and restaurants
- House of Worship

TECHNICAL SPECIFICATIONS

SYSTEM

System's Acoustic Principle	Two-way Vented Enclosure
Frequency Response (-6dB)	75 Hz – 20 kHz
Horizontal/ Vertical Coverage Angle	90° / 60° (-6dB)
Nominal Impedance	8 Ω
Minimum Impedance	7.65 Ω @ 215Hz
Sensitivity (2.83V @ 1m, 2 Pi)	94.5 dB SPL
Maximum (peak) Output	123.5 dB SPL @ 1m

TRANSDUCERS

LF	8" (209mm) neodymium magnet low frequency woofer - 2" (50mm) VC
HF	1" (25mm) exit compression driver - 1" (25mm) aluminum VC

POWER HANDLING

Power Handling (AES)	200 W
Power Handling (prgm)	400 W
LF Power Compression	@ -10 dB Power (40 W) = 0.5 dB @ -3 dB Power (200 W) = 1.5 dB @ 0 dB Power (400 W) = 2.5 dB

ENCLOSURE & CONSTRUCTION

Dimensions (W x H x D)	270 mm (10.6") x 422 mm (16.6") x 250 mm (9.8")
Taper	42°
Enclosure Material	High-density Polypropylene with Metal Grid
Flying System	M8 flying points or dedicated metal bracket
Net Weight	7.6kg (17.6 lbs)



DESCRIPTION

The FL80P is a two-way passive point source loudspeaker that provides full frequency response and controlled dispersion from an easily manageable enclosure. It is designed for many kinds of foreground sound reinforcement applications requiring high quality sound, repeatable performance and convenience of operation in an easily portable format.

The 8" low frequency neodymium driver is matched to a 1" high frequency compression driver with 1" aluminum voice coil, for low weight and good transient response. The custom-designed HF horn that provide wide and accurate coverage of a typical auditorium

The FL80P's symmetrical vented enclosure allows it to adapt to multiple portable and fixed applications, such as front-of-house duties on a speaker stand, or pole mounted on an associated subwoofer or, by using the 42° wedge angle, as a powerful stage monitor.

The compact and lightweight high-density PP cabinet is provided with a 35mm pole mount, three recessed aluminum handles for easy lifting and handing, and M8 rigging points to allow suspension in fixed installations using optional mounting brackets.

MOUNTING AND FIXING

The FL80P can be wall mounted in permanent installations either vertically or horizontally using the KPTLTP or KPTFL80 wall brackets

The KPTLTP wall bracket allows to install the speaker on walls and ceiling with variable tilt and swivel orientation, offering the possibility to obtain a more uniform coverage of the audience. It provides free horizontal aiming and 4 steps at 15° for vertical aiming.

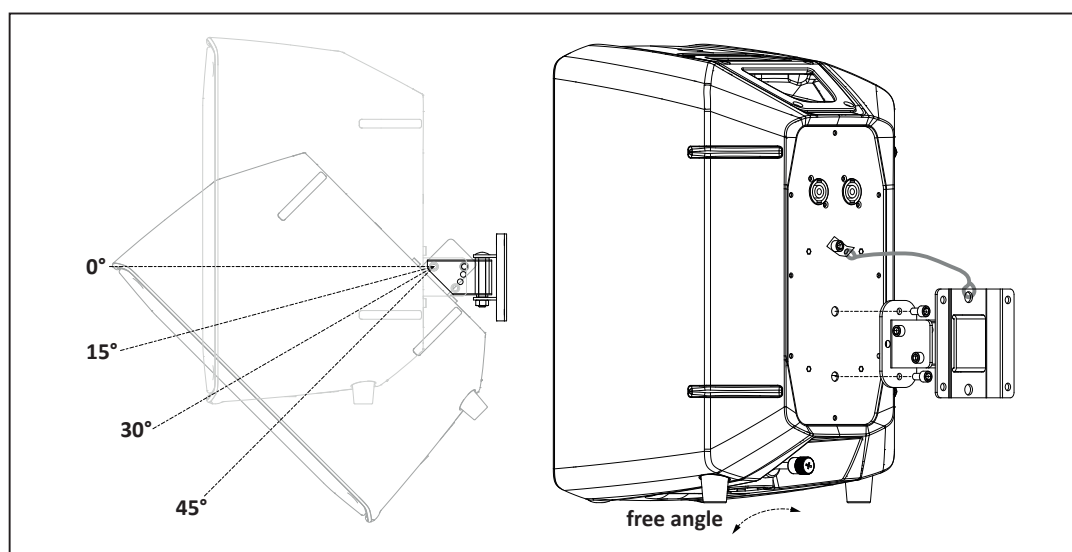
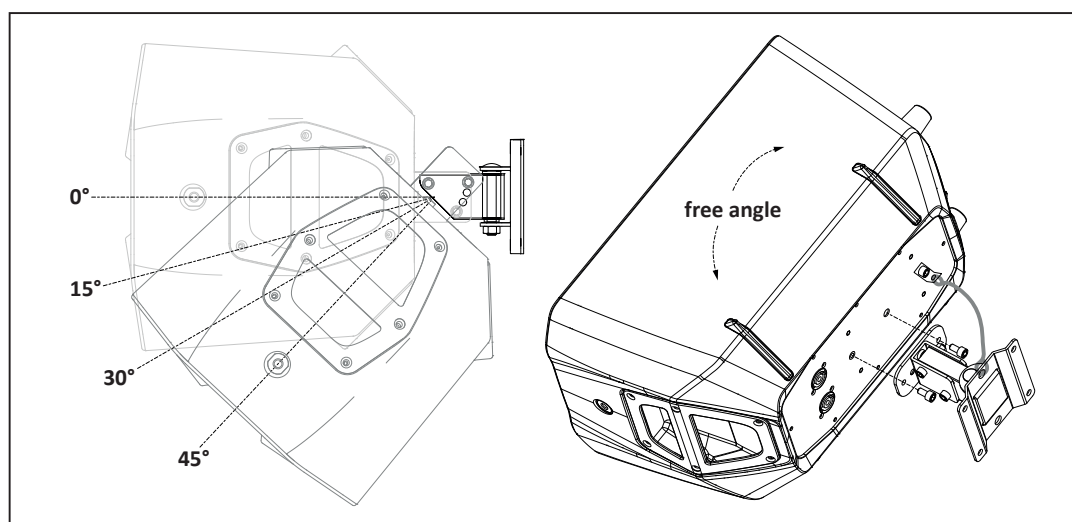

The KPTFL80 c-bracket offers five steps of incremental rotational adjustment for a total of 70°, to enable the loudspeaker to be accurately aimed.

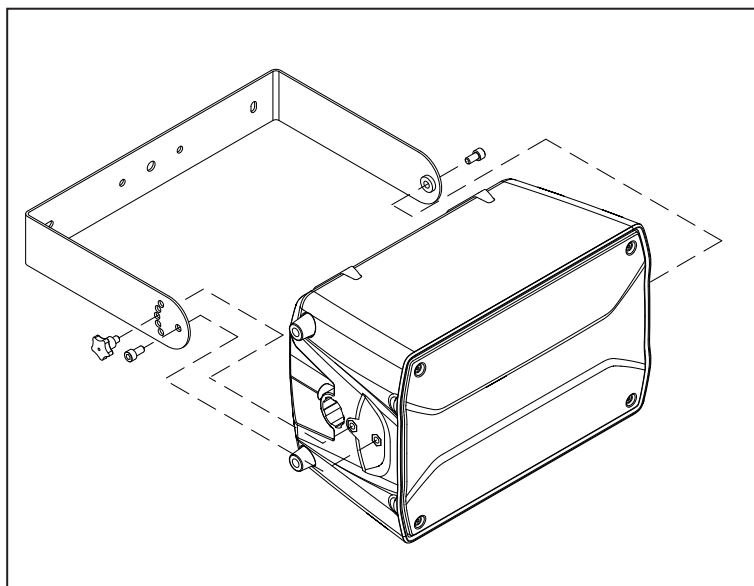
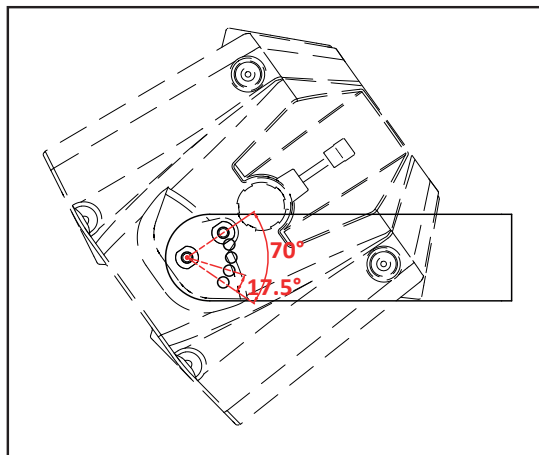

ENGINEERING DRAWING

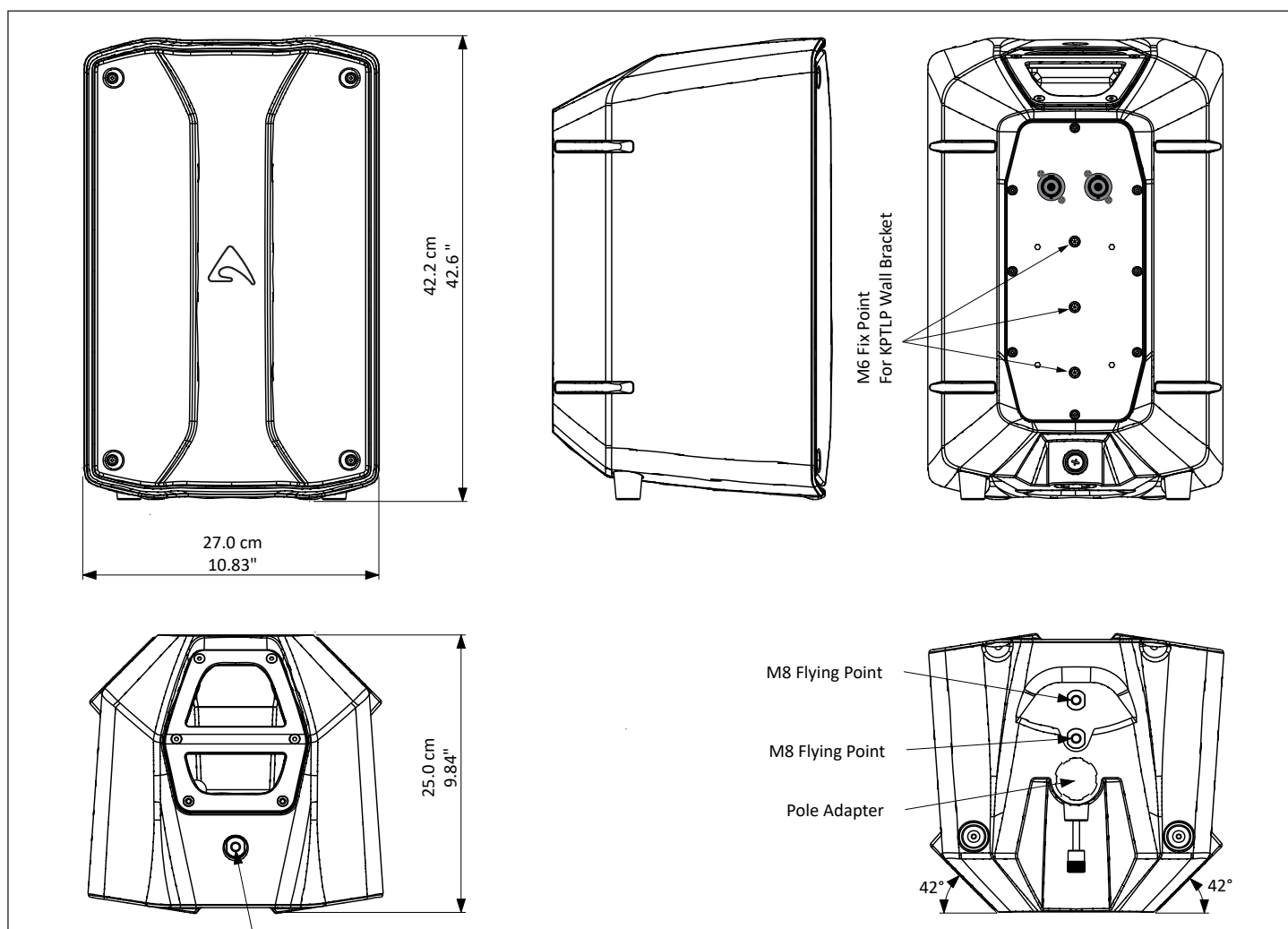

FL80P frequency response

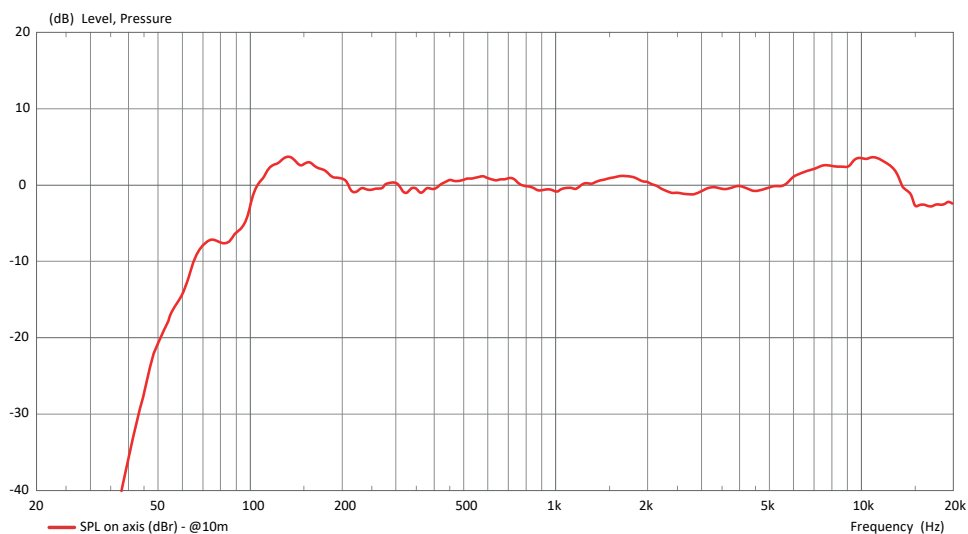

FL80P HORIZONTAL directivity map

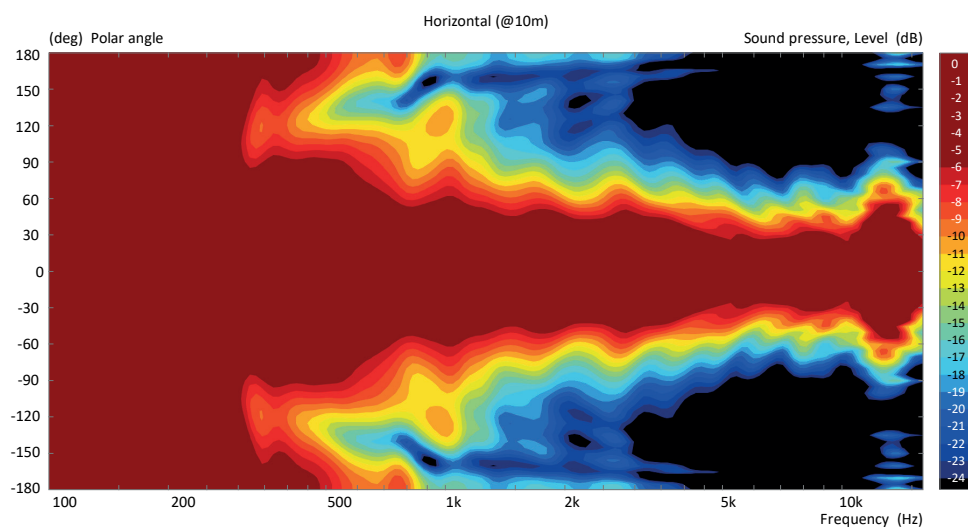

FL80P VERTICAL directivity map

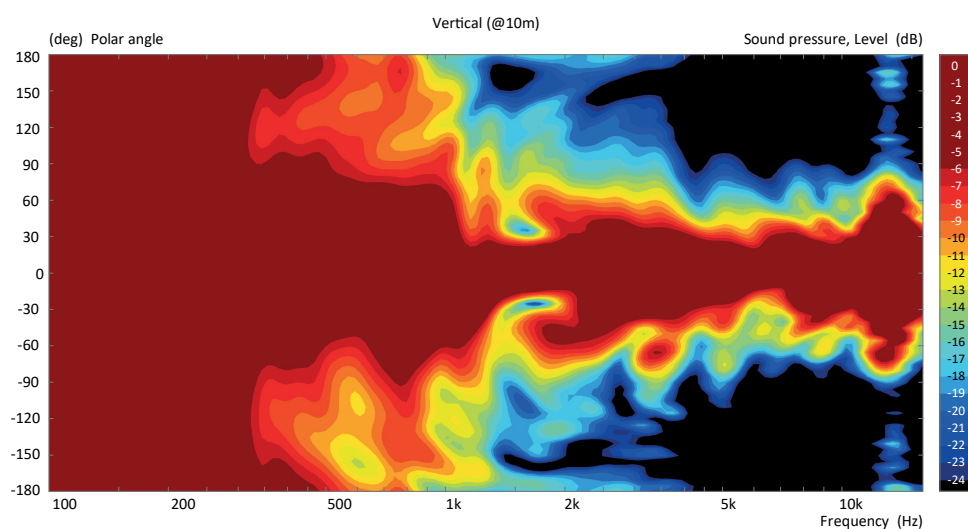

FL80P HF HORIZONTAL polar diagram

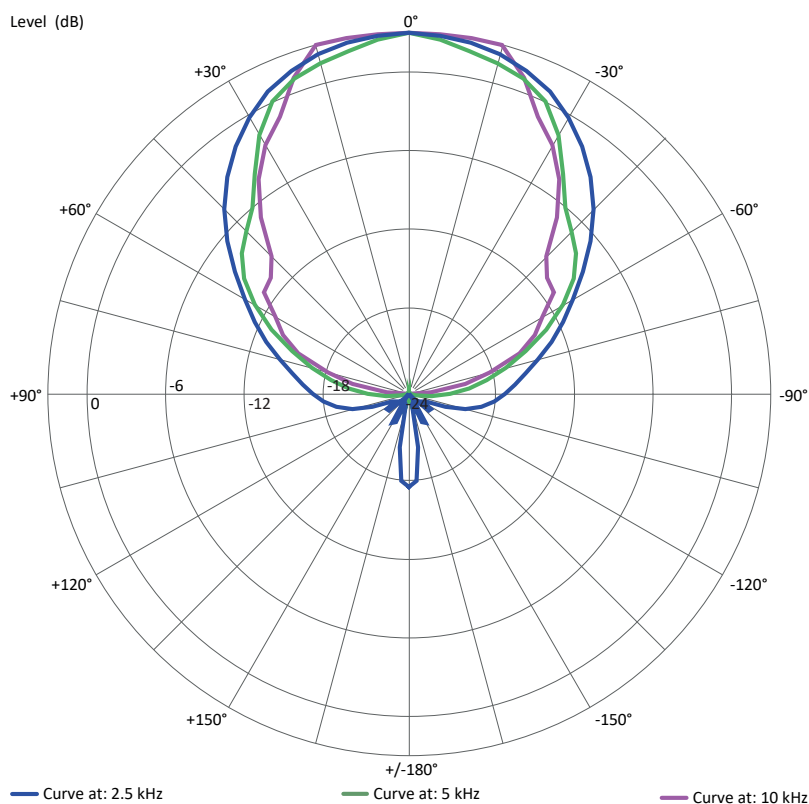

FL80P HF VERTICAL polar diagram

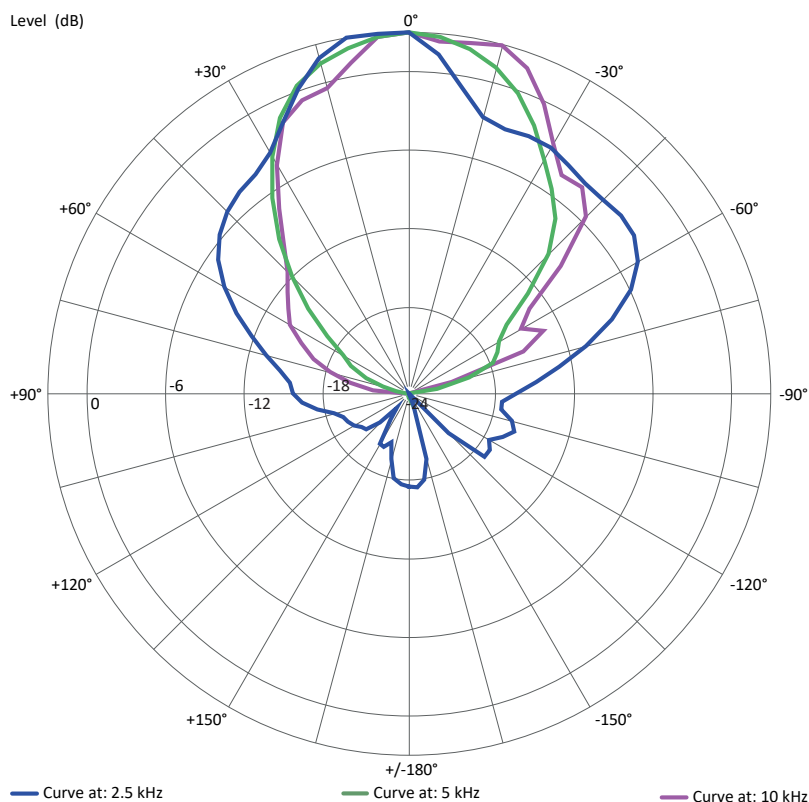

FL80P LF HORIZONTAL polar diagram

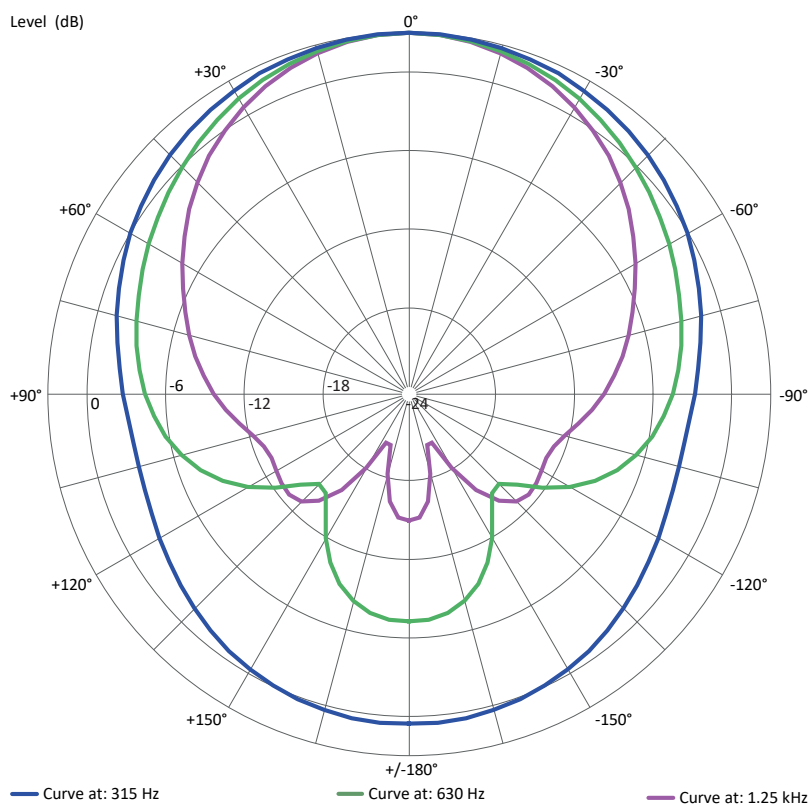

FL80P LF VERTICAL polar diagram

